

## QUICK START GUIDE: MICRON+ TPD SERIES



**Warning:** Risk of electrical shock. carelessness may produce injury or death.



**Warning:** Hot zone with high temperatures. Risk of burns. Use thermal protective equipment.



**Warning:** System under pressure. Risk of burns or particle projection. Use thermal protective equipment and goggles.



**Warning:** Important information for the correct use of the system. may include one or several of the previous hazards, and therefore must be kept in mind to avoid damage and injury.

**Warning:** The Micron+ TPD series melters are equipment with current technology and with certain foreseeable risks. Therefore, only allow qualified personnel with sufficient training and experience to use, install or repair these equipment.

In case of doubts in the moment of installation, refer to the corresponding instructions manual.

If you want this guide in other language, see the website:  
<https://www.meler.eu>



Focke Meler Gluing Solutions, S. A.  
P.I. Arazuri-Orkoien, c/B, nº3 A  
E - 31170 Arazuri - Navarra - Spain  
Tel.: + 34 948 351 110  
e-mail: info@meler.eu  
[www.meler.eu](http://www.meler.eu)  
— Focke Group —



MA-5160-ENG V0920

## 1. COMPONENTS OPTIONS AND ACCESSORIES



## 2. DIMENSIONS/FREE SPACE



Item	Description	Micron+ 5 TPD	Micron+ 10 TPD
A	EQUIPMENT LENGTH	588 mm	671 mm
B	EQUIPMENT WIDTH	380 mm	380 mm
C	EQUIPMENT HEIGHT	600 mm	600 mm
D	EQUIPMENT HEIGHT WITH LID OPEN	747 mm	880 mm
E	EQUIPMENT LENGTH WITH ELECTRICAL CABINET OPEN	838 mm	921 mm

## 3. MELTER FIXATION

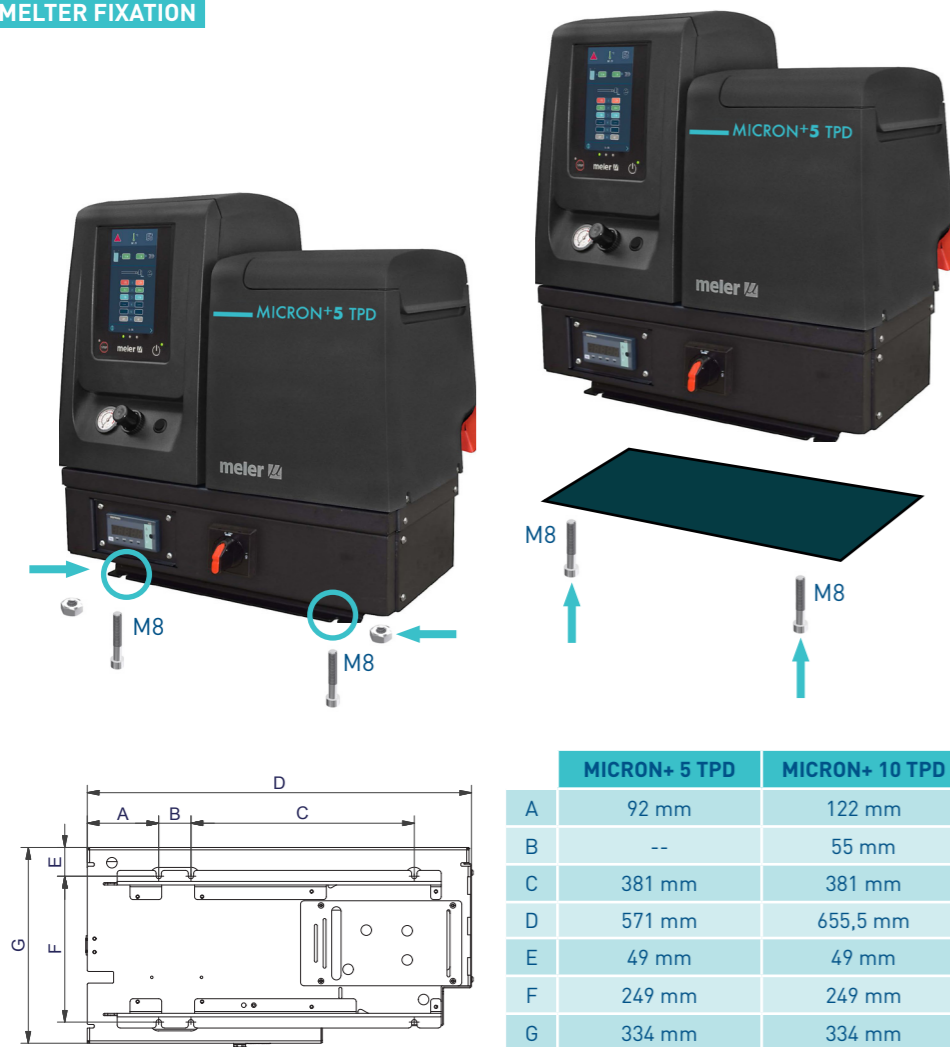

## 4. ELECTRICAL POWER CONNECTION



Equipment	No. Outputs	3 Phases	
		400 VAC Y [1]	
Micron+ 5 TPD	2	10,00 A	
	4	15,65 A	
Micron+ 10 TPD	2	14,35 A	
	4	15,65 A	

(\* Nominal voltage ±10% according to IEC 60038)

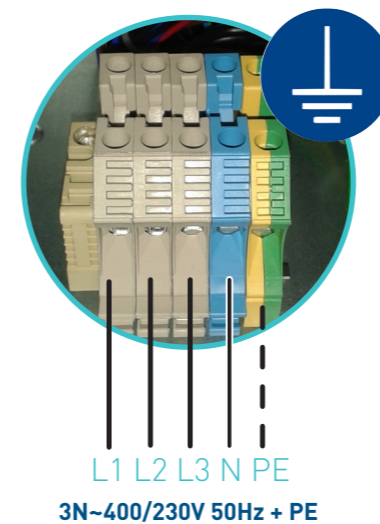

## 5. PNEUMATIC AND HOSE CONNECTION



## 6. MAXIMUM ADHESIVE LOAD

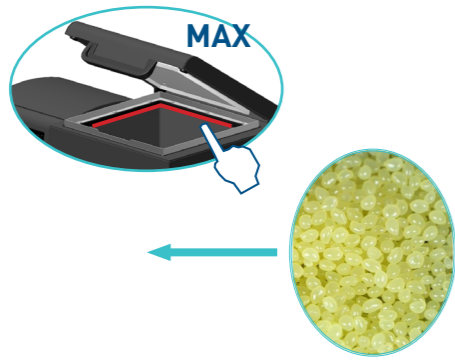

## 7. START UP OF THE MELTER



## 8. CONTROL BOARD: MAIN SCREEN (DATA DISPLAY AND MENU ACCESS)

Alarms  
Level detector (optional)  
Pumping  
Pattern control (optional)

Calendars  
Melter status  
W/o color (blinking): heating up  
Green: temperature  $\geq$  (setpoint-3) °C  
Light blue: standby status  
Grey: inhibición status  
Amber: warning status  
Red: alarm status  
W/o color, w/o value: non connected  
'---' (w/o color): sensor failure

Change of language  
ON/OFF pumping  
ON/OFF display

System time  
Main menu

## 9. LANGUAGE SELECTION

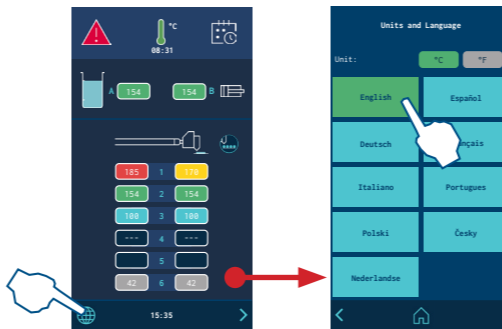

## 10. ENTERING SET POINT AND STANDBY TEMPERATURES

### > Shortcut to setpoint temperatures



### > Access through selection menu

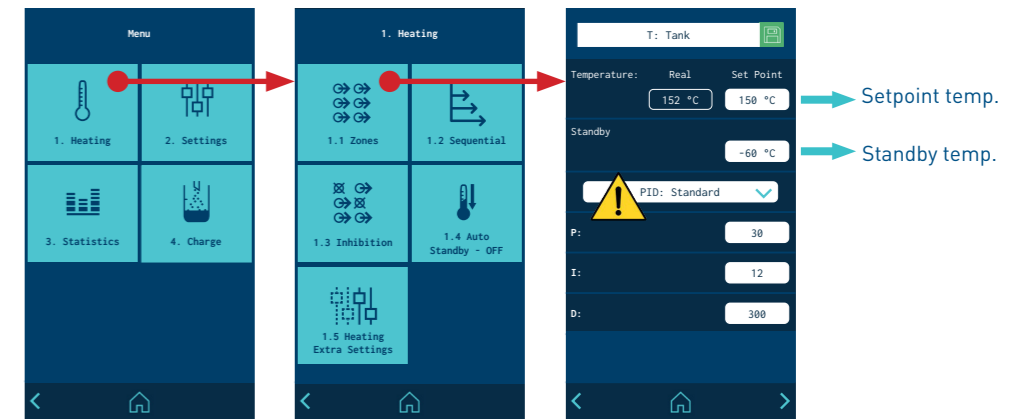

**!** The PID values are directly involved in the heating process. Do not modify these values if you do not have the necessary technical knowledge or without the advice of the Focke Meler Technical Service.

## 11. ENTERING WARNING AND ALARM TEMPERATURE VALUES

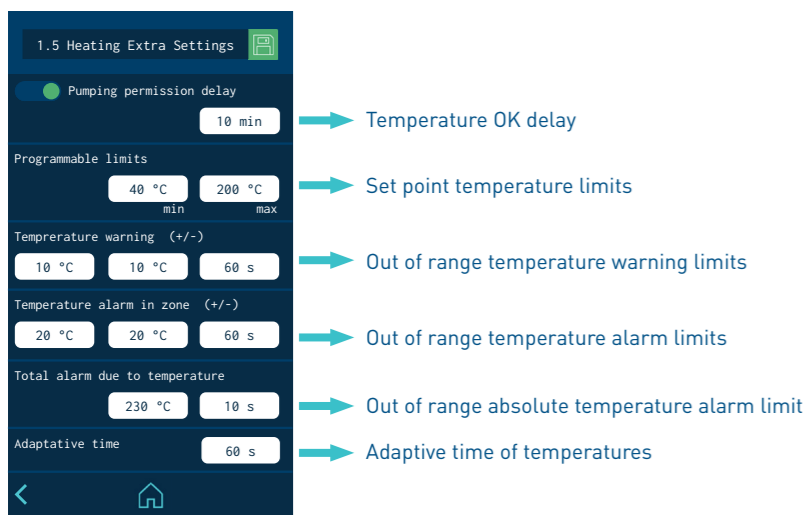

## 12. EXTERNAL INPUT/OUTPUT CONNECTIONS



### > linhibition external control (8 possible groups)



### > External Inputs/Outputs (according to options)

- PROGRAMMABLE INPUTS:
- ON/OFF
  - STANDBY
  - STANDBY/OFF BY ACTIVITY
  - PUMPING ON/OFF
  - COMMUNICATIONS ON/OFF
- PROGRAMMABLE OUTPUTS:
- STANDBY
  - TEMPERATURES OK
  - READY
  - RUNNING
  - ERROR (ALARM ACTIVE)
  - LOW LEVEL
  - LEVEL NOT OK (WARNING LIGHT)

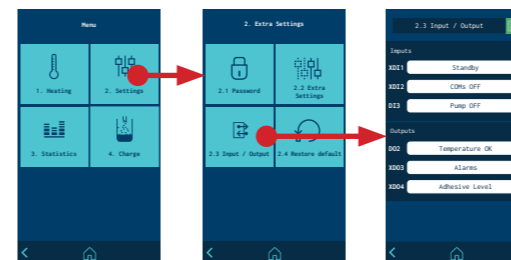

## 13. USE OF HYDRAULIC PRESSURE DISPLAY

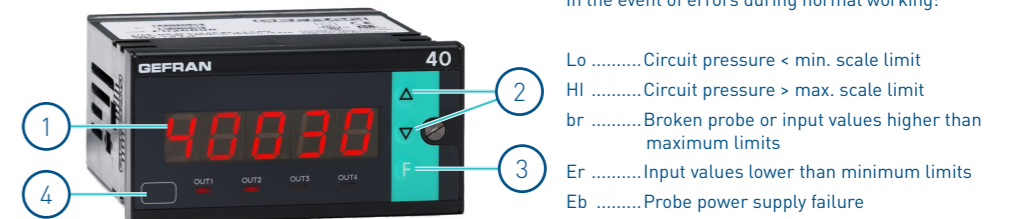

ID	Symbol	Function
1	40000	Shows the process variable, the menu identification, the parameters identification and the error codes.
2	▲	Increases/Decreases the value of the parameter displayed until max/min value is reached.
	▼	Held down: progressively increases the speed of increasing/decreasing the value displayed.
3	F	Used to move between the various menus and parameters of the instrument. Confirms the value of the current parameter (or parameter edited using ▲▼) and selects the next parameter.
4	bar	Position where to apply the label with unit of measure.

Immediately after switching on the instrument carries out a self-diagnostic test.

During the test, all the display segments and the 4 indicator lights will flash, when finished, enters normal work mode and displays pressure value.